

THE DRAWING AND ALL TECHNICAL INFORMATION IS THE SOLE PROPERTY OF A.D. METRO. NO PARTS OF THIS DRAWING OR THE INFORMATION CONTAINED HEREIN ARE TO BE REPRODUCED, COPIED, OR TRANSMITTED IN ANY FORM OR BY ANY MEANS, ELECTRONIC OR MECHANICAL, INCLUDING PHOTOCOPYING, RECORDING, OR BY ANY INFORMATION STORAGE AND RETRIEVAL SYSTEM, WITHOUT THE WRITTEN PERMISSION OF A.D. METRO.

REVISIONS			
LET	DESCRIPTION	DATE	BY
A	INITIAL RELEASE	01-28-08	DZ
B	UPDATE DRAWING INFORMATION	06-19-09	DZ
C	CHANGE DRAWING STYLE	12-23-09	DZ

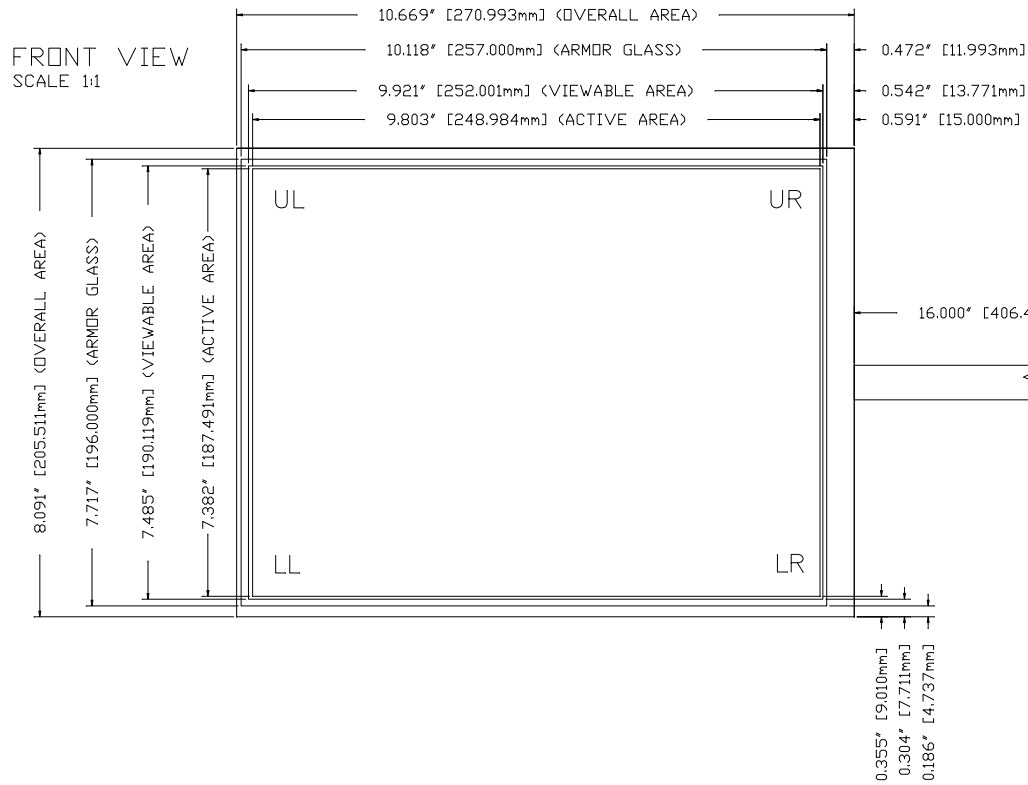

PIN	X1
1	LL
2	UL
3	SENSE
4	LR
5	UR

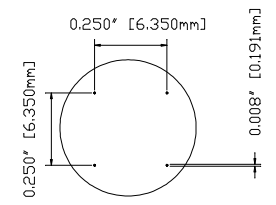
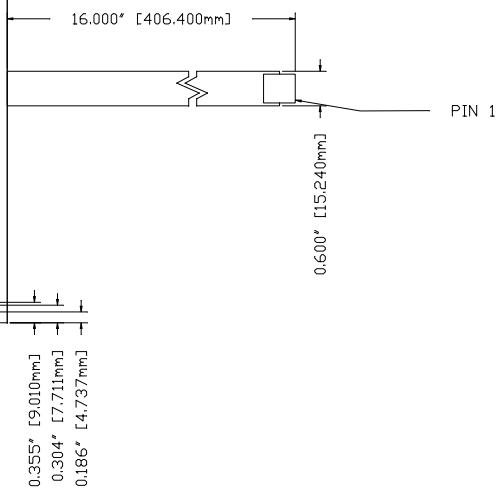

DETAIL A - DOT SPEC  
SCALE 5:1

NOTES:

- SUBSTRATE: 3.18MM ITO GLASS
- ALL DIMENSIONS IN INCHES [MILLIMETERS]
- SAFETY SEAM ON ALL EDGES
- CABLE: 5-PIN FFC TYPE
- CONNECTOR: AMP TYPE WITH 0.1" [2.54MM] CENTERS, NON LATCHING, PART NUMBER 487378-4
- TOUCH SCREEN TO BE ACTIVATED WITHIN ACTIVE AREA ONLY. AREA BETWEEN ACTIVE AND VIEWABLE AREAS MUST HAVE A SCREENED ON DIELECTRIC.
- TOTAL SENSOR THICKNESS: 0.142" [3.600MM].
- LINEARITY PATTERN: PEPPER.

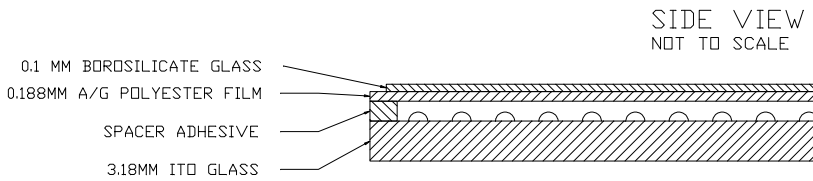

**ADmetro** A.D. METRO - 1181 PARISEN ST - OTTAWA, ONTARIO

**AD12.1ULTRA**

TOLERANCING UNLESS OTHERWISE SPECIFIED XXX ANGLES 90°	DRAWN BY: DZ DATE: 12-23-09	PROJECT/ASSET NO.: ---	SCALE: ---
3D NET SCALE DRAWING	PROJECT NAME: ---	PART NO.: 3A99110	SHEET: 1 OF 1